



AUSTRALIAN RAIL TRACK CORPORATION LTD

Southern Sydney Freight Line IMPORTANT COMMUNITY INFORMATION

Construction Work at Minto Station

Australian Rail Track Corporation (ARTC) will be undertaking construction work near Minto Station. This work must be undertaken outside normal construction hours because there are safety risks involved with working in close proximity to the overhead wires and tracks.

The work will consist of locating a new compressor hut, isolation transformer and receiver tanks adjacent to the down track.

The work will be undertaken on one weekend from 7am to 6pm Saturday and 8am to 6pm Sunday on either the 6th and 7th, 13th and 14th, or 20th and 21st August 2011. There is an approved contingency for a second weekend of work in this period.

The equipment used will include a crane, low loader and flat bed truck.

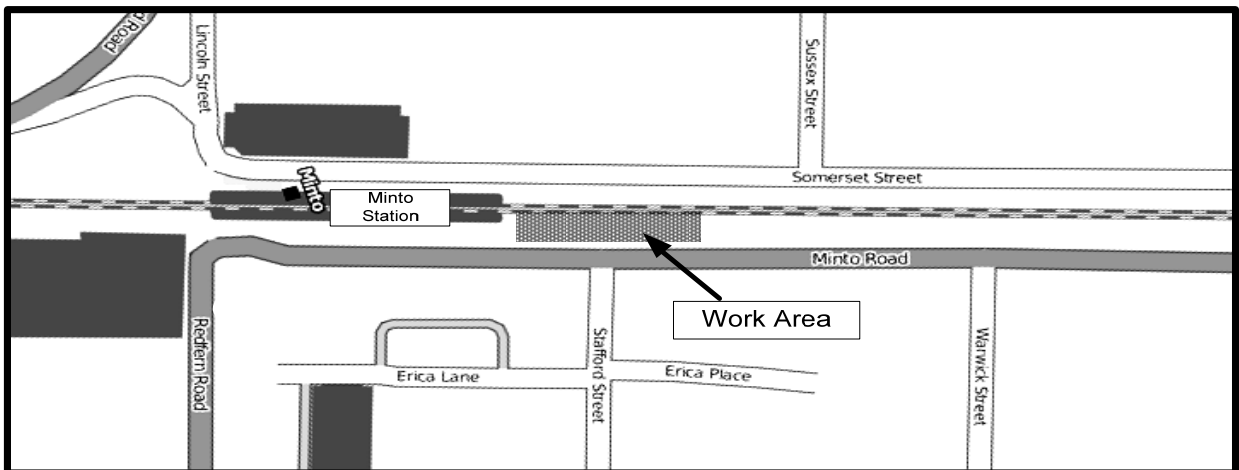

We appreciate your patience while we build this important project for Sydney and NSW.

For further information please phone our 24 Hour Information and Complaints Line on 1800 182 543 or email ssfl@artc.com.au or visit www.ssfl.artc.com.au



Translating & Interpreting Service – Please Phone: 131 450