

THIS DRAWING HAS BEEN REDUCED

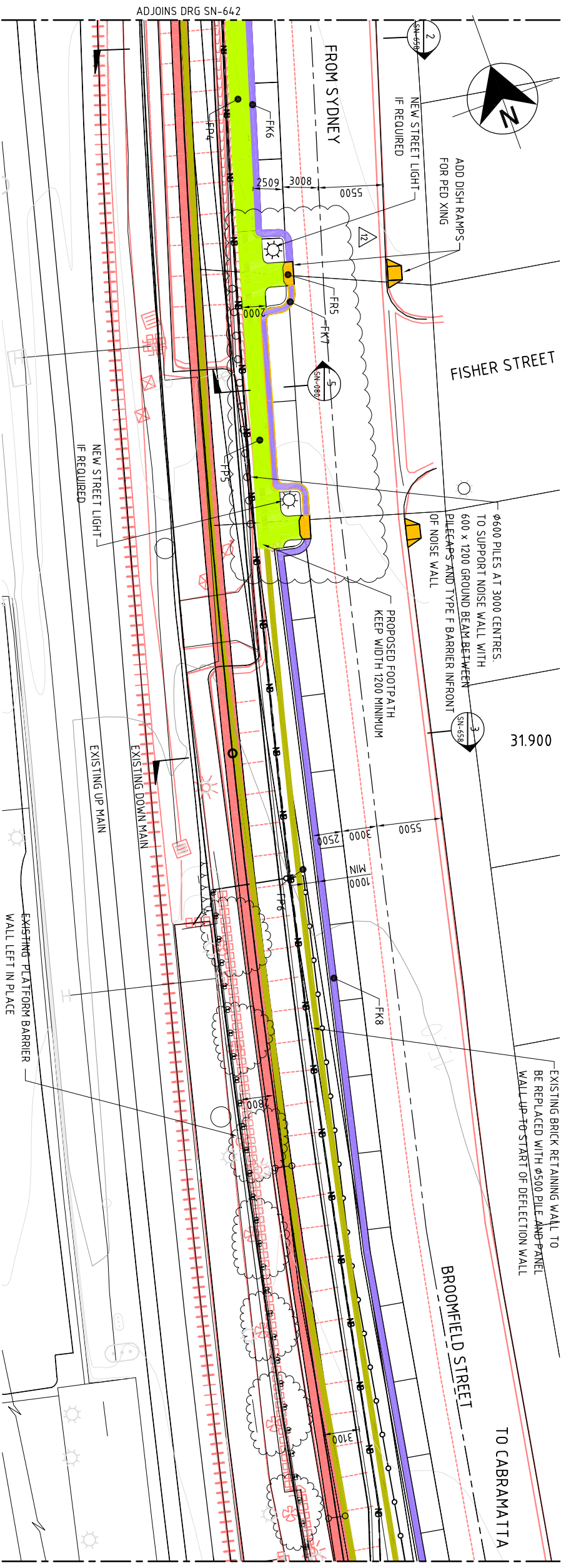

CABRAMATTA STATION SURFACE PLAN
1:200

LEGEND

— NB — NOISE BARRIER

— (B) — REFERENCE NUMBER

BANKSTOWN (B)
CITY COUNCIL (F)
FAIRFIELD (F)
CITY COUNCIL (L)
LIVERPOOL (L)
CITY COUNCIL (C)
CAMPBELLTOWN (C)
CITY COUNCIL

— (R) — RAMP
— (K) — KERB
— (P) — PATH
— (A) — ASPHALT
— (C) — CONCRETE SURF / BASE
— (G) — GATE
— (IK) — ISLAND KERB
— (B) — PLANTER BOX
— (D) — DRIVE WAY RAMP
— (T) — THRESHOLD

NEW PROPOSED ITEMS:

— (Y) — GATE
— (G) — KERB
— (R) — ROAD / CAR PARK PAVING
— (O) — DRIVE WAY RAMP
— (C) — CONCRETE
— (G) — GATE
— (Y) — FOOTPATH
— (O) — PEDESTRIAN RAMP / CROSSING & SPEED BUMPS

ITEMS TO CONFORM:

— WITH COUNCIL SPECIFICATIONS
— SITE LEVELS
— REFER TO CROSS SECTION DETAILS

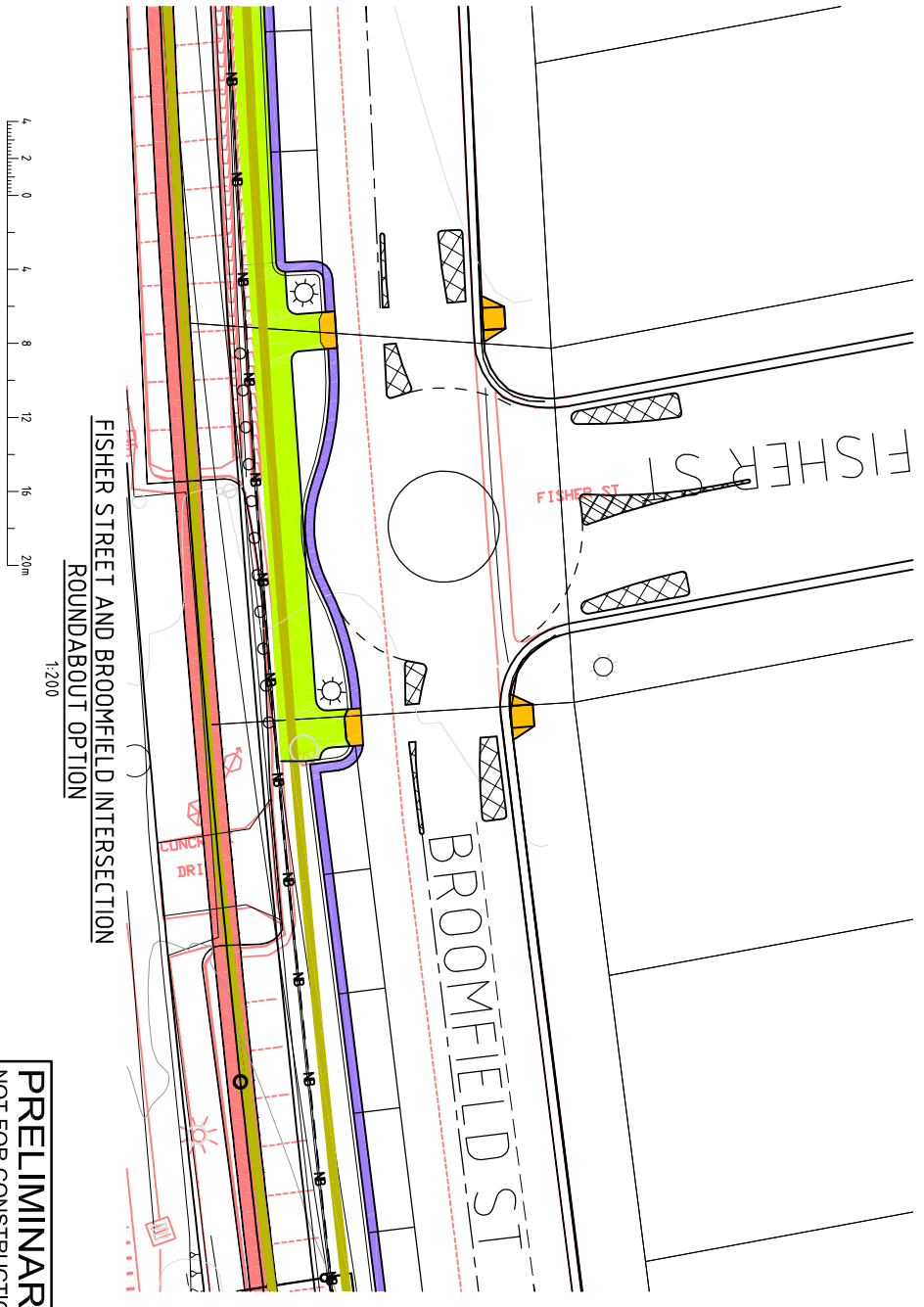

PRELIMINARY
NOT FOR CONSTRUCTION

07	04.10.07	REVISED TENDER DESIGN ISSUE	ARTS		
06	31.08.07	TENDER DESIGN ISSUE	ARTS		
12	26.09.08	PRELIMINARY DETAIL DESIGN - CONTRACT ISSUE	CP		
11	29.07.08	PRELIMINARY DETAIL DESIGN - TENDER ISSUE	CP		
10	21.12.07	REVISED TO RAIL CORP COMMENTS	MWM		
09	15.11.07	TENDER ADDENDUM ISSUE	ARTS		
08	26.10.07	TENDER DESIGN RE-ISSUE	FT		
Rev	Date	Revision Details	Dim	Ver.	App

Connell Wagner

Connell Wagner Pty Ltd
116 Military Road (PO Box 538) Neutral Bay
New South Wales 2089 Australia
Telephone: +61 2 9465 5598
Facsimile: +61 2 9465 5598
Email: connw@connwagner.com

ARTIC
AUSTRALIAN RAIL TRACK CORPORATION LTD

Client: **ARTIC**

Project: **SOUTHERN SYDNEY FREIGHT LINE**

Drawn	Signed	Date	Drawn	Signed	Date
ARTS	ARTS		ARTS	ARTS	
Designed	Signed	Date	Verified	Signed	Date
CJM	CJM		GM	GM	
Approved	Signed	Date	Approved	Signed	Date
PR	PR		PR	PR	

Drawing Title: **CABRAMATTA TO GLENFIELD STATION CABRAMATTA STATION GENERAL ARRANGEMENT SHEET 5**

Project No.	559D
Scale	AS SHOWN
Sheet Size	A1
Drawing No.	SN-644
Rev.	12